

PRELIMINARY

H B H
ENGINEERS
501 E First Street
Newberg, Oregon 97132
CONSULTING 503/554-9553 fax 503/537-9554
email: mail@hbh-engineers.com

Designed By: MCD | Drawn By: MCD | Checked By: MDH | Submitted No.:
H:\2018\014-Design\DWG\Site Plan - Stair Alternate.dwg | Layout: Bid Set
Site Plan

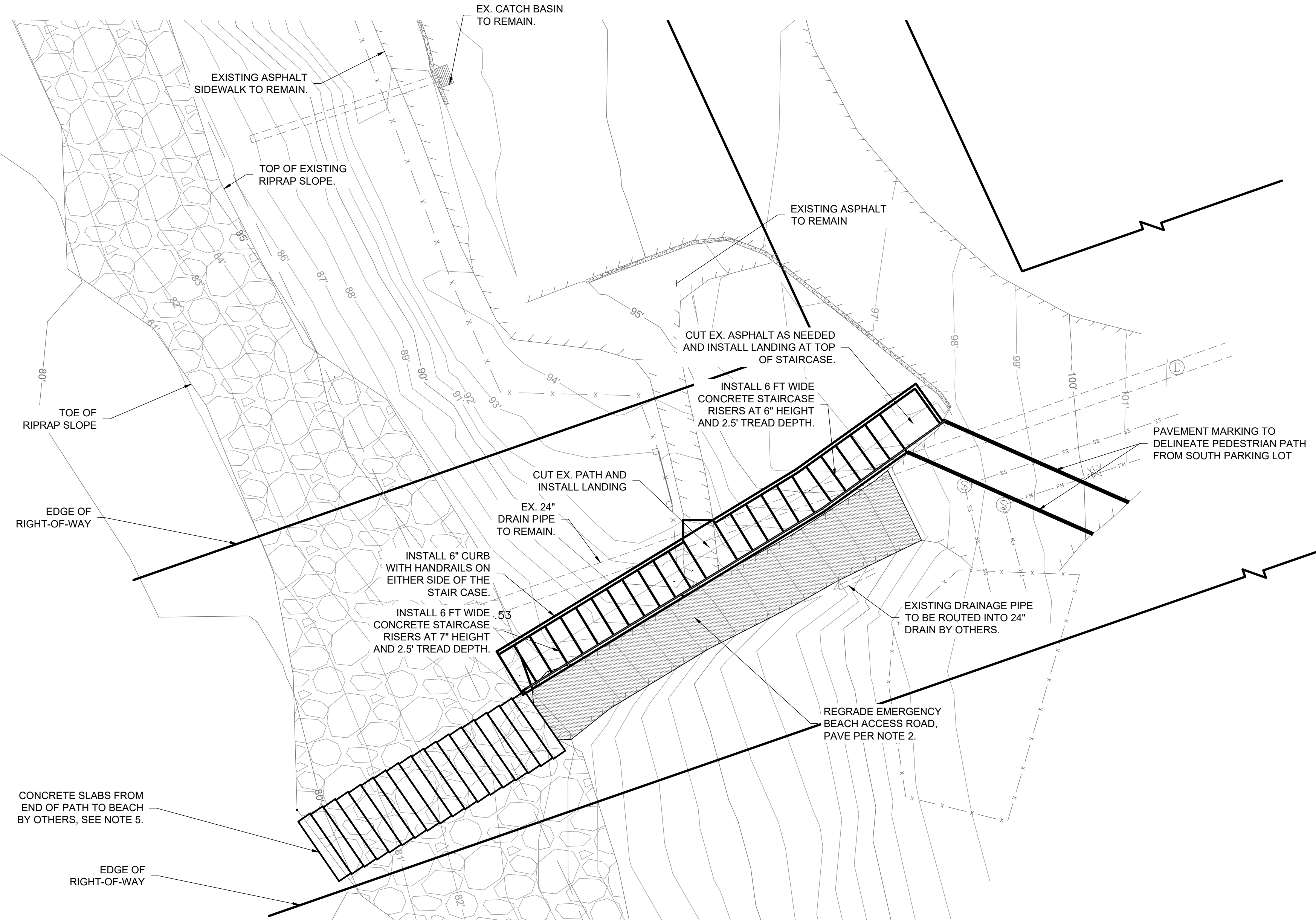
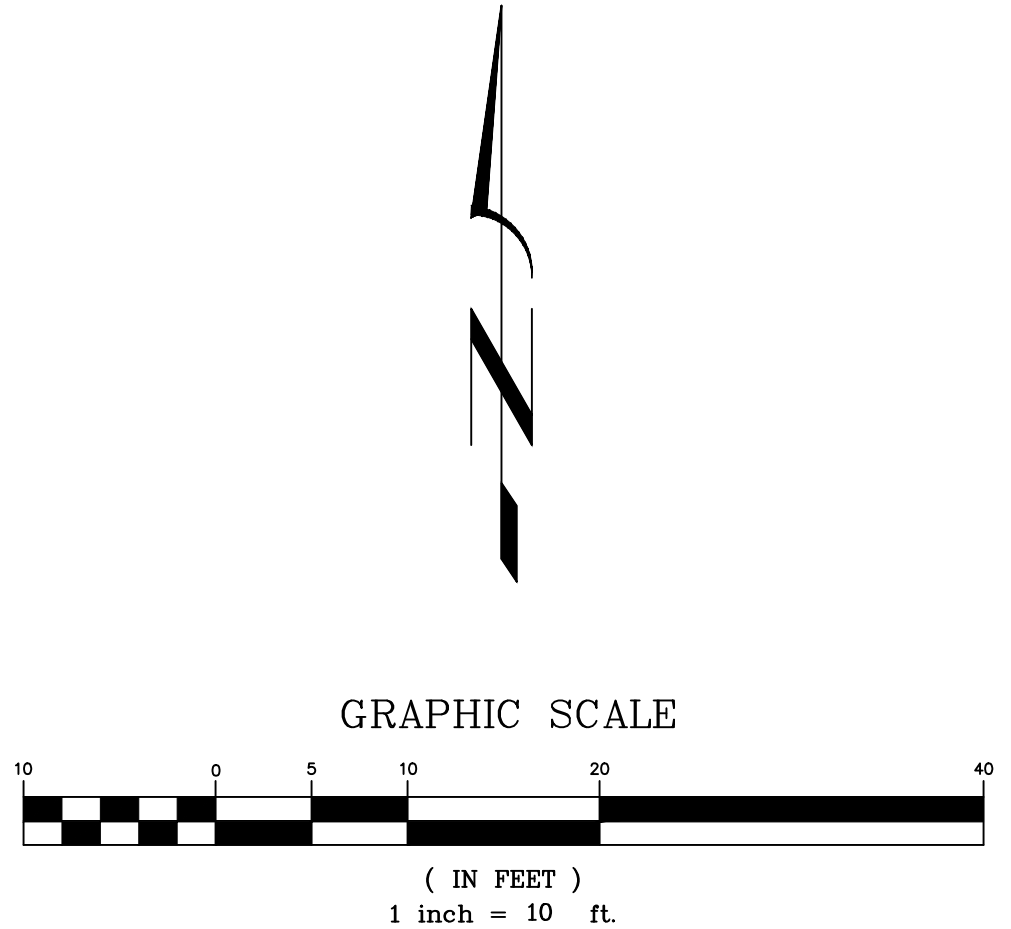

- NOTES:**
- 1) NEW PATH SHALL BE CONSTRUCTED OF PCC MINIMUM 3000 PSI.
 - 2) ASPHALTIC CONCRETE (AC) PAVEMENT SHALL BE 1/2 DENSE LEVEL II HMAC AS DEFINED IN THE CURRENT OREGON STANDARD SPECIFICATIONS FOR CONSTRUCTION (OSSC).
 - 3) CRUSHED ROCK SHALL BE SIZED AS SHOWN ON PLANS AND SHALL BE AS DEFINED IN THE CURRENT OSSC.
 - 4) DESIGN BUILD ADA HANDRAIL SHALL BE COMPOSED ENTIRELY OF 316 STAINLESS STEEL OR MATERIALS RATED TO LIMIT WEATHERING AND CORROSION IN COASTAL ENVIRONMENTS WITH HIGH SALT CONTENTS IN THE AIR. GALVANIZED HANDRAILS WILL NOT BE ACCEPTED.
 - 5) CONCRETE SLABS TO BE MANUFACTURED SHIPPED, AND UNLOADED IN THE PARKING LOT. INSTALLATION OF SLABS ON THE BEACH IS NOT PART OF THIS CONTRACT. DESIGN AND INSTALLATION OF SLABS BY OTHERS.

- STAIRCASE NOTES**
- 1) EXISTING VEGETATION SHALL BE STRIPPED TO A DEPTH OF 18".
 - 2) FILL ON EITHER SIDE OF CURB AS NECESSARY TO MATCH EX. GROUND. PLANT VEGETATION ON ALL EXPOSED DISTURBED AREAS TO MATCH EX.

OCEANSIDE BEACH ACCESS SCALE: 1" = 10'

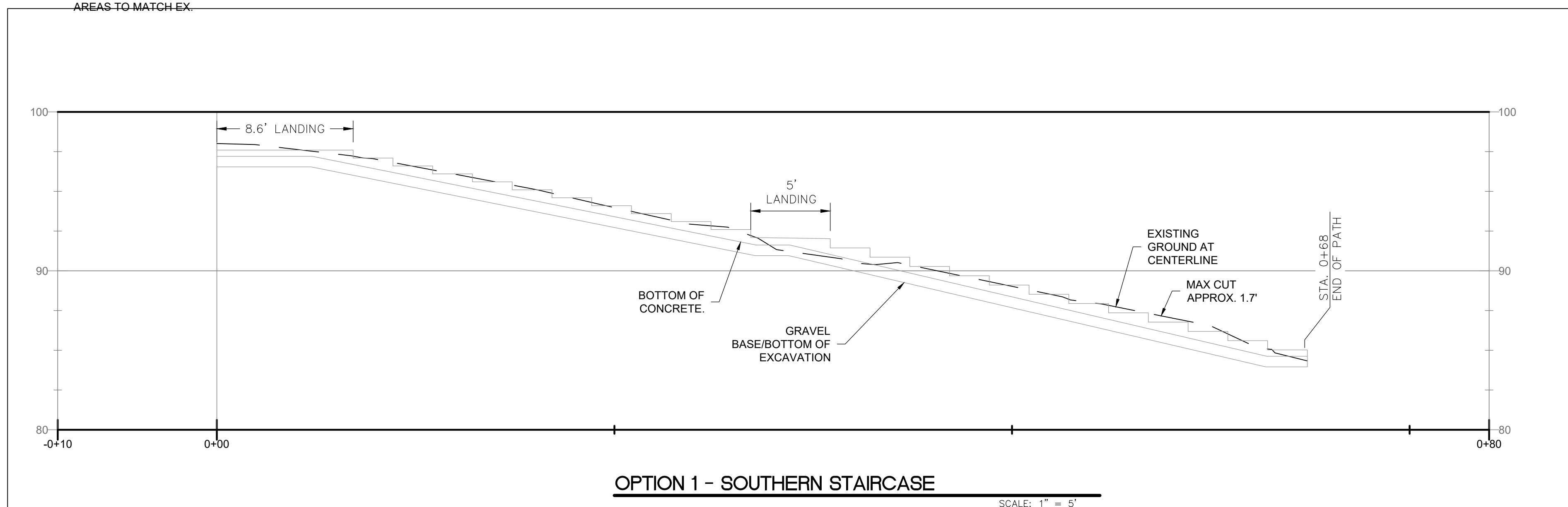

OPTION 1 - SOUTHERN STAIRCASE SCALE: 1" = 5'

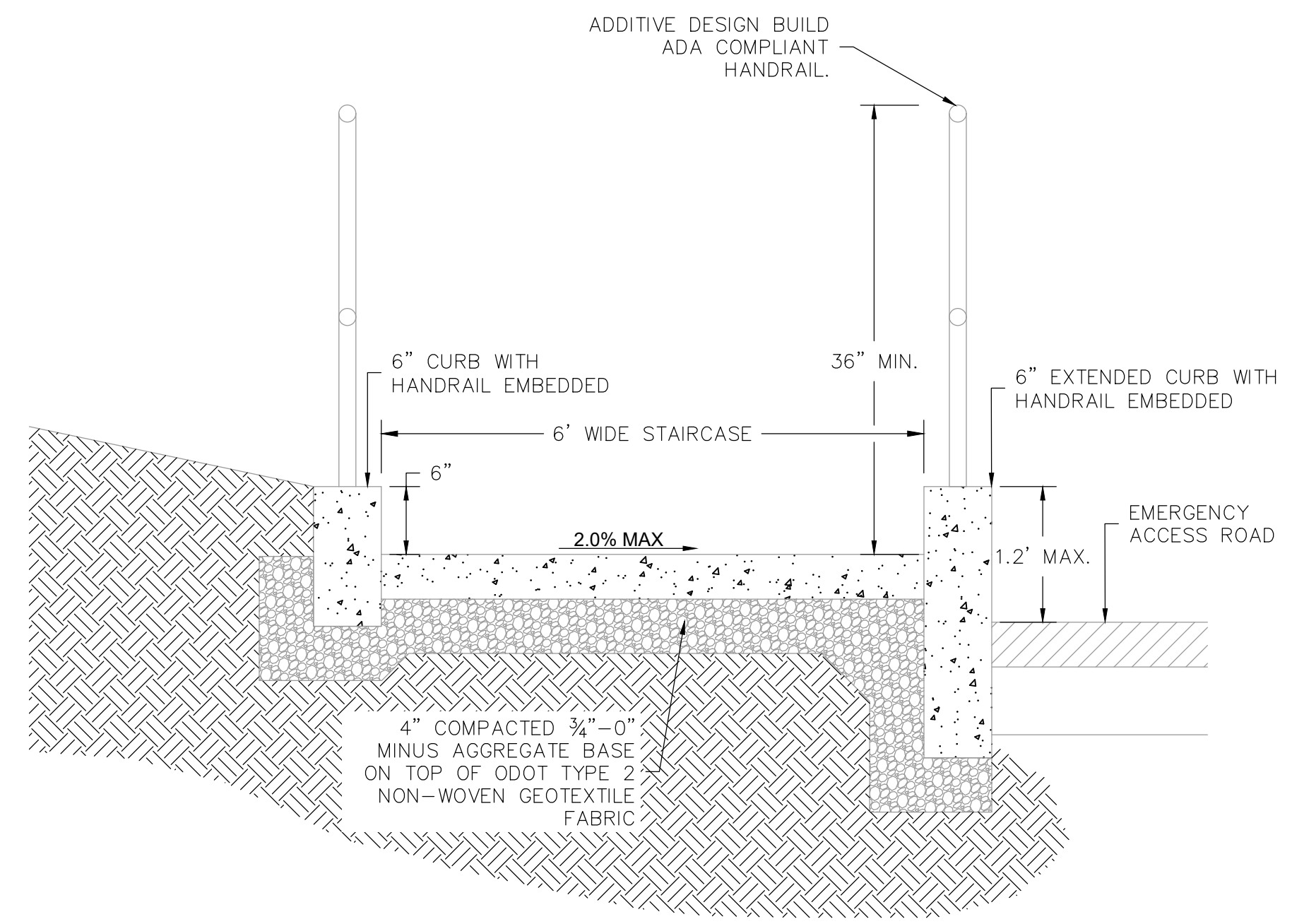

TYPICAL STAIRCASE SECTION NTS

REV.	DATE	DESCRIPTION
1	10/1/2019	SHIFTED SLABS TO REMAIN IN COUNTY ROW

IF THIS LINE IS NOT 1/8\"/>

OCEANSIDE NEIGHBORHOOD ASSOCIATION
CLIENT ADDRESS
**OCEANSIDE BEACH ACCESS
OCEANSIDE, OR
CONCEPTUAL SITE PLAN**